



P.O. Box 3365 South El Monte, CA 91733 626.444.0541 Fax 626.444.3887 www.Afcon.org

371

CLEVIS HANGER - STANDARD

SIZE - 1/2 thru 30 inch pipe.

MATERIAL - Carbon Steel.

FINISH - Plain, E.G., H.D.G. and S.S.

LISTING/APPROVAL - Conforms to Federal Specification WW-H-171E, type 1, and Manufacturers Standardization Society SP-69, type 1.

OSHPD OPA-0601 See Website.

FUNCTION - Recommended for the suspension of non-insulated, stationary pipe lines.

ORDERING - Part #, pipe size and finish.

NOTE: Hanger load nut above clevis must be tightened securely to assure proper hanger performance. When an oversized clevis is used, a pipe Spacer should be placed over the cross bolt to assure that the lower U-strap will not move in on the bolt. Maximum Temperature: 650°F.

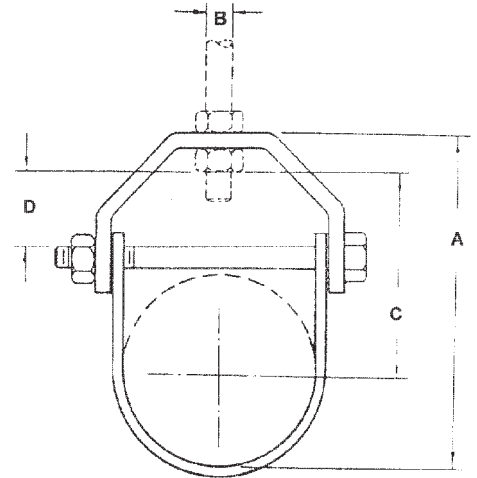

PIPE SIZE	A	ROD SIZE B	C	D	CROSS BOLT	STOCK SIZE		MAX REC. LOADS LBS.
						TOP	BOTTOM	
1/2	2 7/8	3/8	1 3/16	1	1/4	1/8 x 1	1/8 x 1	610
3/4	3 1/16	3/8	1 7/8	1	1/4	1/8 x 1	1/8 x 1	610
1	3 3/8	3/8	2 1/16	1	1/4	1/8 x 1	1/8 x 1	610
1 1/4	3 3/4	3/8	2 1/4	1	1/4	1/8 x 1	1/8 x 1	610
1 1/2	4 1/16	3/8	2 3/8	1	1/4	1/8 x 1	1/8 x 1	610
2	4 1/2	3/8	2 3/4	1	1/4	1/8 x 1	1/8 x 1	610
2 1/2	5 1/2	1/2	3 1/4	1 1/4	3/8	3/16 x 1 1/4	3/16 x 1 1/4	1130
3	6 1/8	1/2	3 1/2	1 1/4	3/8	3/16 x 1 1/4	3/16 x 1 1/4	1130
3 1/2	6 3/4	1/2	3 3/4	1 1/4	3/8	3/16 x 1 1/4	3/16 x 1 1/4	1130
4	7 5/8	5/8	4 1/4	1 1/2	3/8	1/4 x 1 1/4	3/16 x 1 1/4	1430
5	8 7/8	5/8	5 1/4	1 1/2	1/2	1/4 x 1 1/4	3/16 x 1 1/4	1430
6	10	3/4	5 1/2	1 1/2	1/2	1/4 x 1 1/2	3/16 x 1 1/2	1940
8	12 3/4	7/8	7 1/8	2	5/8	1/4 x 1 1/2	3/16 x 1 1/2	2000
10	17 1/8	7/8	11 1/8	3 1/4	3/4	3/8 x 1 3/4	1/4 x 1 3/4	3600
12	18 5/8	7/8	11 5/8	3 1/2	3/4	3/8 x 2	1/4 x 2	3800
14	21	1	12 5/16	3 13/16	7/8	1/2 x 2	1/4 x 2	4200
16	22 1/16	1	12 7/16	2 5/8	1	1/2 x 2 1/2	1/4 x 2 1/2	4600
18	24 3/4	1	13 15/16	3 7/8	1 1/8	1/2 x 2 1/2	1/4 x 2 1/2	4800
20	27 3/8	1 1/4	14 7/16	4	1 1/4	5/8 x 3	3/8 x 3	4800
* 24	31 5/8	1 1/4	17 1/2	4 1/4	1 1/4	5/8 x 3	3/8 x 3	4800
* 30	39 1/8	1 1/4	21 7/8	5	1 1/4	3/4 x 3	3/8 x 3	6000

* Furnished with pipe spacer to support Max. Load Rating.

