

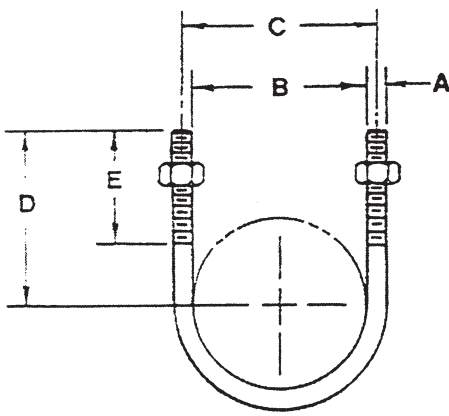

P.O. Box 3365 South El Monte, CA 91733 626.444.0541 Fax 626.444.3887 www.Afcon.org

241

U-BOLT LIGHT WEIGHT



| PIPE SIZE | ROD SIZE A | B | C | D | E | MAX. REC. LOAD LBS.* | APPROX. WEIGHT/C |
|-----------|------------|---------|---------|---------|-------|----------------------|------------------|
| 1/2 | 5/16 | 15/16 | 1 3/16 | 1 15/16 | 1 3/4 | 485 | 8 |
| 3/4 | 5/16 | 1 1/8 | 1 3/8 | 2 1/16 | 1 3/4 | 485 | 8 |
| 1 | 5/16 | 1 3/8 | 1 5/8 | 2 3/16 | 1 3/4 | 485 | 9 |
| 1 1/4 | 5/16 | 1 11/16 | 1 15/16 | 2 3/8 | 1 3/4 | 485 | 9 |
| 1 1/2 | 5/16 | 2 | 2 1/4 | 2 7/16 | 1 3/4 | 485 | 10 |
| 2 | 5/16 | 2 7/16 | 2 11/16 | 2 11/16 | 1 3/4 | 485 | 11 |
| 2 1/2 | 3/8 | 2 15/16 | 3 5/16 | 3 1/16 | 2 | 1220 | 31 |
| 3 | 3/8 | 3 9/16 | 3 15/16 | 3 3/8 | 2 | 1220 | 33 |
| 3 1/2 | 3/8 | 4 1/16 | 4 7/16 | 3 5/8 | 2 | 1220 | 36 |
| 4 | 3/8 | 4 9/16 | 4 15/16 | 3 7/8 | 2 | 1220 | 40 |
| 5 | 3/8 | 5 5/8 | 6 | 4 9/16 | 2 1/4 | 1220 | 47 |
| 6 | 1/2 | 6 3/4 | 7 1/4 | 5 1/16 | 2 1/4 | 2260 | 125 |
| 8 | 1/2 | 8 3/4 | 9 1/4 | 6 1/16 | 2 1/4 | 2260 | 156 |
| 10 | 5/8 | 10 7/8 | 11 1/2 | 7 1/4 | 2 1/4 | 3620 | 318 |

SIZE - 1/2 thru 10 inch pipe.

MATERIAL - Carbon Steel.

FINISH - Plain, E.G., H.D.G., and S.S.

FUNCTION - For supporting or anchoring suitable light loads.

ORDERING - Part #, pipe size and finish.

NOTE: When furnished hot-dip galvanized, oversize hex nuts must be used.

