

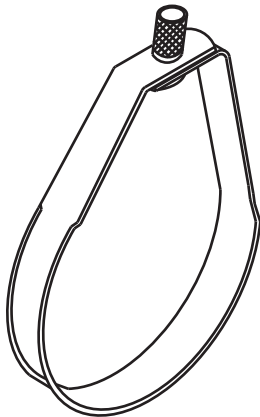

P.O. Box 3365 South El Monte, CA 91733 626.444.0541 Fax 626.444.3887 www.Afcon.org

300

RING HANGER



1 thru 4 inch pipe
LISTED FOR STEEL/CPVC



1/2 & 3/4 inch pipe
5 thru 8 inch pipe

NFPA 13				
PIPE	ROD	1 WT.	5 WT.+250	UL TEST LOAD
1	3/8	30.75	403.75	750
1 1/4	3/8	43.95	469.75	750
1 1/2	3/8	54.15	520.75	750
2	3/8	76.95	634.75	750
2 1/2	3/8	118.35	841.75	850
3	3/8	162.30	1061.50	1050
4	3/8	246.00	1480.00	1500
5	1/2	349.45	1996.75	2000
6	1/2	476.35	2631.75	2650
8	1/2	711.00	3805.00	4050

SIZE - ROD- 3/8" or 1/2"

SIZE - SYSTEM PIPE - 1/2" thru 8"

MATERIAL - Carbon Steel.

FINISH - Mil. Galvanized to G-90 specification.

LISTING/APPROVAL -

US 203-EX 2551 1"- 8" Approval guide - 1"- 8" **OSHPD** OPA-0601 See Website.

Conforms to Federal Specification WW-H-171E type 10, and
Manufacturers Standardization Society SP-69, type 10.

MAXIMUM TEMPERATURE - 650°F.

FUNCTION - Pipe component of an *AFCON* hanger.

To support horizontal steel, CPVC or copper pipe.

INSTALLATION - Per these instructions including NFPA 13 and the
CPVC manufacturers instructions.

FEATURES

- * Sized and listed exclusively for use with #310 Surge Restrainer.
- * Band edge is offset for EASY pipe insertion.
- * Custom fit swivel nut for better retention in ring.

ORDERING - Part #, pipe size.

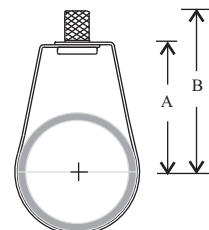

PIPE	A	B
1	1.8793	2.5259
1 1/4	2.1382	2.7850
1 1/2	2.2673	2.9140
2	2.6048	3.2516
2 1/2	2.7500	3.5080
3	3.0625	3.8205
4	3.5625	4.3205
5	4.0940	4.9397
6	4.6250	5.4707
8	7.5620	8.4077

